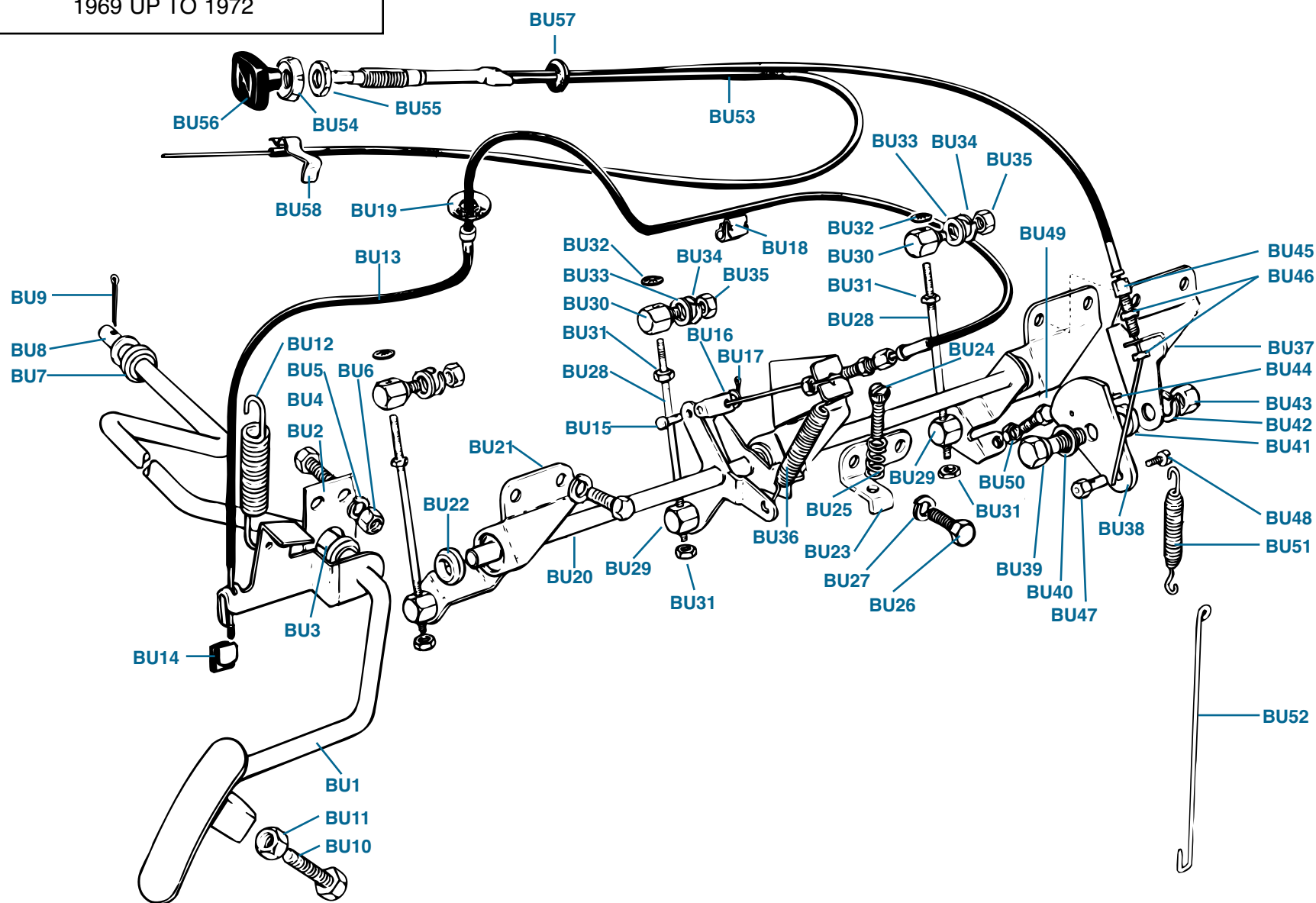

PLATE BV

ACCELERATOR PEDAL AND
THROTTLE LINKAGE—P.I. MODELS,
1969 UP TO 1972



ACCELERATOR PEDAL & THROTTLE LINKAGE—P.I. MODELS, 1969 UP TO 1972

Plate No.	Part No.	Description	No. Off
ACCELERATOR PEDAL DETAILS			
BV1	214420	Accelerator Pedal Assembly, R.H.S.	1
	148951	Accelerator Pedal Assembly, L.H.S.	1
BV2	148526	BEARING PLATE ASSEMBLY, R.H.S.	1
	148954	BEARING PLATE ASSEMBLY, L.H.S.	1
BV3	138490	Bearing, nylon, pedal shaft, mounted in plate	1
		HARDWARE , securing bearing plate assembly to pedal box	
BV4	HU705	Screw, set	2
BV5	WL207	Washer, lock	2
BV6	HN2007	Nut	2
BV7	138490	Bearing, nylon, pedal shaft, mounted in hole in bulkhead	1
		HARDWARE , retaining and locating pedal shaft	
BV8	WP9	Washer, plain	1
BV9	PC9	Pin, cotter	1
		PEDAL STOP DETAILS, R.H.S.	
BV10	HU816	Screw, set	1
BV11	HN2008	Nut, locking screw	1
BV12	149793	Spring, pedal return	1
		PEDAL STOP DETAILS, L.H.S.	
	HU708	Screw, set	1
	JN2108	Nut, jam, locking screw	1
	27645	Spring, pedal return	1
		THROTTLE CONTROL CABLE DETAILS	
BV13	149005	Throttle Control Cable Assembly, R.H.S.	1
	149004	Throttle Control Cable Assembly, L.H.S.	1
BV14	613766	Clip, edge, retaining cable end to accelerator pedal, R.H.S.	1
	149042	Clip, push-on, retaining cable end to accelerator pedal, L.H.S.	1
		HARDWARE , securing cable end to throttle lever	
BV15	PJ8504	Pin, joint	1
BV16	WP5	Washer, plain	1
BV17	PC5	Pin, cotter	1
BV18	610562	Clip, cable to R.H. valance, R.H.S.	1
	149725	Retainer, securing cable to dash shelf, L.H.S. only	1
BV19	131492	Washer, sealing hole in dash shelf	1
	516510	P-Clip, retaining cable to battery fixing rods, L.H.S. only	2

Plate No.	Part No.	Description	No. Off
COUNTERSHAFT DETAILS			
BV20	149604	Countershaft Assembly, fitted up to engine number CP50000	1
	153978	Countershaft Assembly, fitted after engine number CP50000	1
BV21	148927	Bearing Bracket Assembly, securing countershaft to manifold	2
BV22	138490	Bearing, nylon, countershaft pivot	2
BV23	149618	Bracket, throttle stop	1
BV24	PT508	Screw, set, throttle stop adjusting	1
BV25	149552	Spring, on set screw	1
		HARDWARE , securing brackets to intake manifolds	
BV26	HU705	Screw, set	6
BV27	WL207	Washer, lock	6
		THROTTLE LINK DETAILS, up to engine no. CP26804	
	149537	Link, connecting, throttle, center	1
	149536	Swivel Post, center link, upper	1
	149535	Swivel Post, center link, lower	1
	149537	Link, connecting, throttle, front and rear	1
	149780	Trunnion, front and rear links, upper	2
	149535	Swivel Post, front and rear links, lower	2
	HN2005	Nut, securing upper swivel post and upper trunnions to connecting links	5
		HARDWARE , securing trunnions and swivel posts to countershaft levers and to throttle levers	
	WP6	Washer, plain	6
	WL205	Washer, lock	6
	HN2005	Nut	6
		THROTTLE LINK DETAILS, from engine no. CP26805 up to CR1	
BV28	152889	Link, connecting, throttles	3
BV29	152724	Swivel Post, lower	3
BV30	149780	Trunnion, upper	3
		HARDWARE , securing swivel posts and trunnions to connecting links	
BV31	HN2005	Nut, one under each lower swivel and one under each upper trunnion	6
BV32	FX3203	Fix, round, upper side of each upper trunnion	3
		HARDWARE , securing trunnions and swivel posts to countershaft levers and to throttle levers	
BV33	WP6	Washer, plain	6
BV34	WL205	Washer, lock	6
BV35	HN2005	Nut	6
BV36	145197	Spring, countershaft return	1

(Continued on next page.)