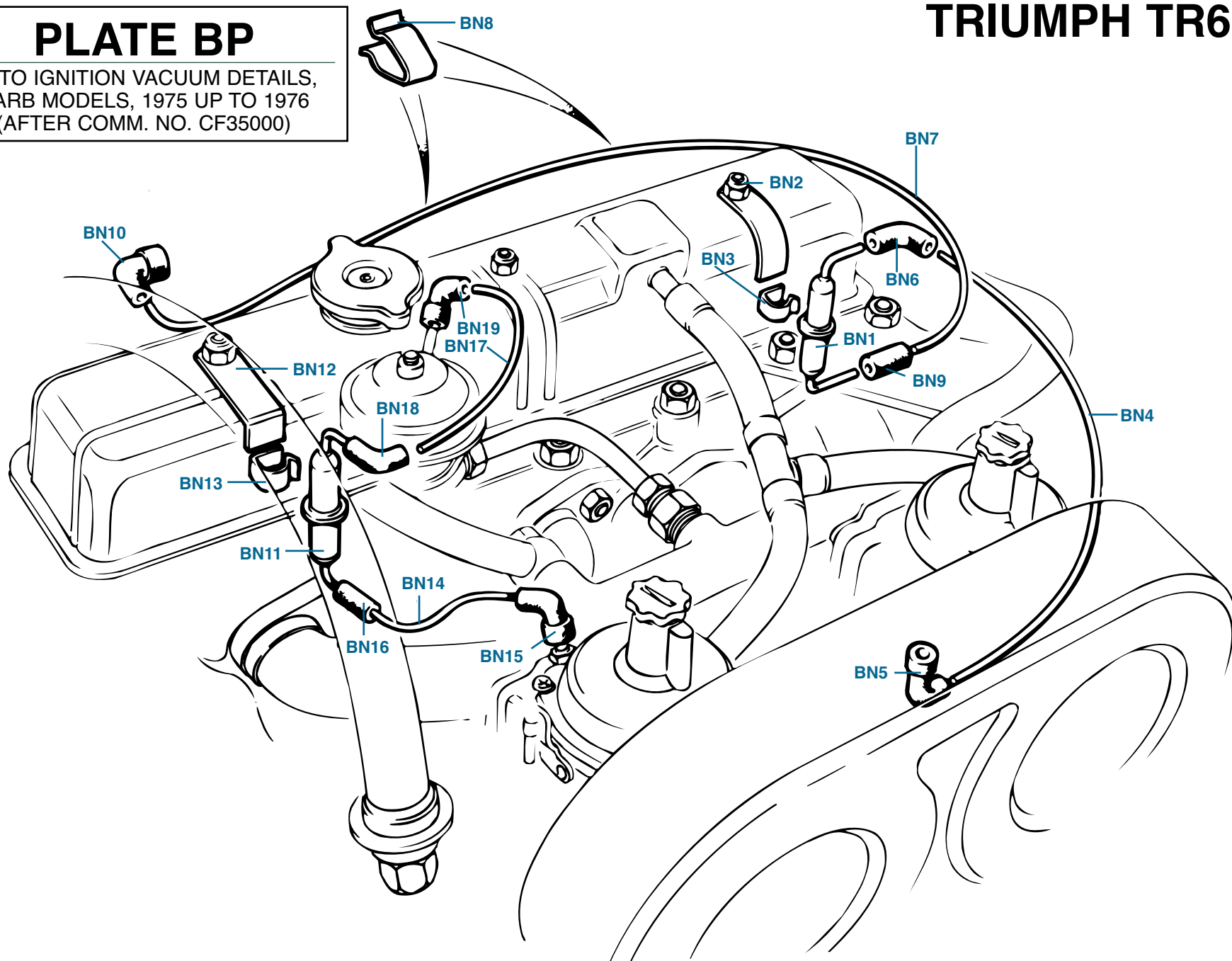

PLATE BP

AUTO IGNITION VACUUM DETAILS,
CARB MODELS, 1975 UP TO 1976
(AFTER COMM. NO. CF35000)



AUTO-IGNITION VACUUM DETAILS-CARB MODELS, 1975 UP TO 1976 (AFTER COMM.NO. CF35000)

Plate No.	Part No.	Description	No. Off
	RFK348	AUTO IGNITION VACUUM PIPES AND FITTINGS KIT, comprising everything listed below	1
BP1	156607	Fuel Trap Assembly, front	1
BP2	UKC5474	Bracket, mounting fuel trap to front valve cover fixing stud	1
BP3	156712	Clip, securing fuel trap to bracket	1
BP4	UKC2111	Tube, suction, from front carburettor to fuel trap	1
BP5	152184	Fitting, rubber, connecting tube to front carburettor	1
BP6	149380	Fitting, rubber, connecting tube to fuel trap	1
BP7	UKC2114	Tube, suction, from fuel trap to distributor vacuum retard unit	1
BP8	138892	Clip, anchoring tube to fuel pipe	2
BP9	156608	Fitting, rubber, connecting tube to fuel trap	1
BP10	128262	Fitting, rubber, connecting tube to vacuum retard unit	1
BP11	156607	Fuel Trap Assembly, rear	1
BP12	UKC2187	Bracket, mounting fuel trap to rear valve cover fixing stud	1
BP13	156712	Clip, securing fuel trap to bracket	1
BP14	UKC2118	Tube, suction, from rear carburettor to fuel trap	1
BP15	154184	Fitting, rubber, connecting tube to rear carburettor	1
BP16	156608	Fitting, rubber, connecting tube to fuel trap	1
BP17	151105	Tube, suction, from fuel trap to E.G.R. valve	1
BP18	149380	Fitting, rubber, connecting tube to fuel trap	1
BP19	152184	Fitting, rubber, connecting tube to E.G.R. valve	1

Plate No.	Part No.	Description	No. Off
-----------	----------	-------------	---------